



PANAGET

3, rue d'Orgères
35230 Bourgbarré
Tél.: 02.99.05.77.77
Fax: 02.99.57.73.55
www.panaget.com

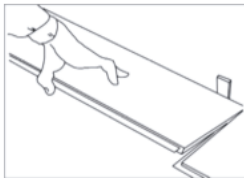

Laying floating wood flooring without glue "2beclic"

The new 2beclic system can be fitted both longitudinally and laterally. It involves a simple movement by the fitter to click the boards into place.



1• Roll out the ISOL 30 underlay, ensuring the sub- floor is flat and dry. The panels are taped together side-by-side and should fit along the walls.

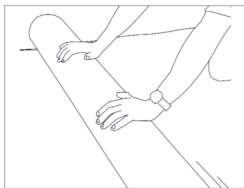

2• Start to lay the strips in a corner, facing opposite the wall, and move from right to left. Position the tongue side of the strip against the wall (cut the tongue off to allow for the expansion gap). Insert wedges in the expansion gap. This must be 1,5mm per 1m of parquet, with a minimum of 8mm. Add a small amount of glue to the bottom of the groove (width-wise), wipe off any excess glue.

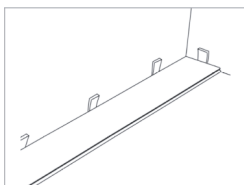

3• Place the second strip at the end of the previous one. Continue the same process as for the first row.

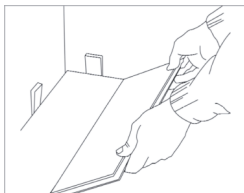

4• Employ the off-cut of the first row to start the second one.

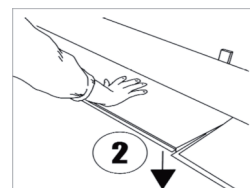
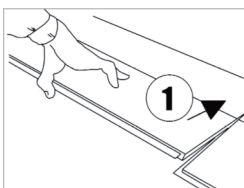

5• Position the following strip end-to-end with the preceding one, inclining it at an angle of around 30 degrees, while fitting it against the horizontal tongue (longitudinal locking). Push the lower section of the strip down, until it is in contact with the floor (lateral locking). Continue like this for the rest of the row. The strips are locked into place once the rest of the rows have been fitted.

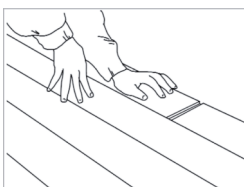

6• Cut the strips for the last row to the required width, not forgetting the expansion gap. For the final row, fit the strips in place flatly. Add a small amount of glue to the bottom of the groove, widthwise (removing any excess glue).