

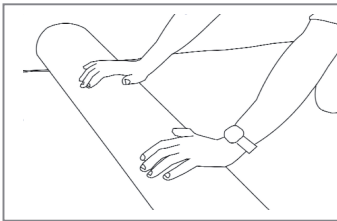

PANAGET

3, rue d'Orgères
35230 Bourgarré
Tél.: 02.99.05.77.77
Fax: 02.99.57.73.55
www.panaget.com

Laying floating wood flooring with glue

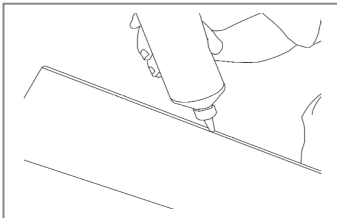

1• Roll out the ISOL 30 underlay, ensuring the sub-floor is flat and dry. The panels are taped together side-by-side and should fit along the walls.



2• Generally, the strips are laid parallel to the longest side of the room. Laying begins in a corner with the groove against the wall. Place the spacers around the periphery. The expansion gap must be 1,5mm per 1m of parquet with a minimum of 8mm.

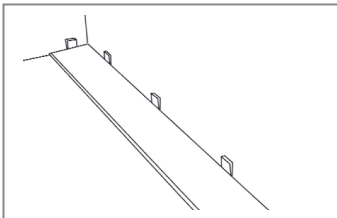

3• When laying, carefully spread glue on the upper edge of the tongues along the whole length with our Presto BIB glue.

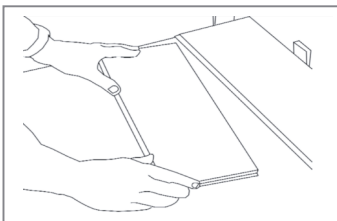

4• Start the 2nd row with the offcut from the last strip in the previous row. Make sure that the offcut is at least twice as wide as the strip for aesthetic reasons. Clean off all traces of glue immediately using a dampened cloth or sponge.

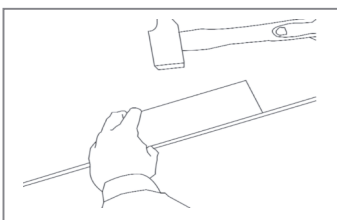

5• Use a tapping block or a wooden spacer to avoid damaging the strips when interlocking them.

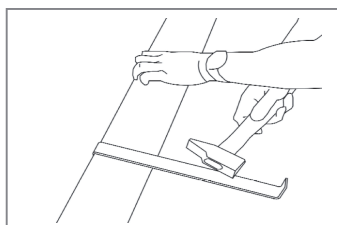

6• Cut the strips for the last row to the required width, not forgetting the expansion gap. Use a metallic flattening hammer for interlocking. Remove the wedges 24 hours after laying. Finish laying the floor by covering the surrounding gap with a Panaget skirting board.